

OVERALL SITE PLAN OF PREWITT POINT AT OSAGE BEACH, MO

OCTOBER, 2005

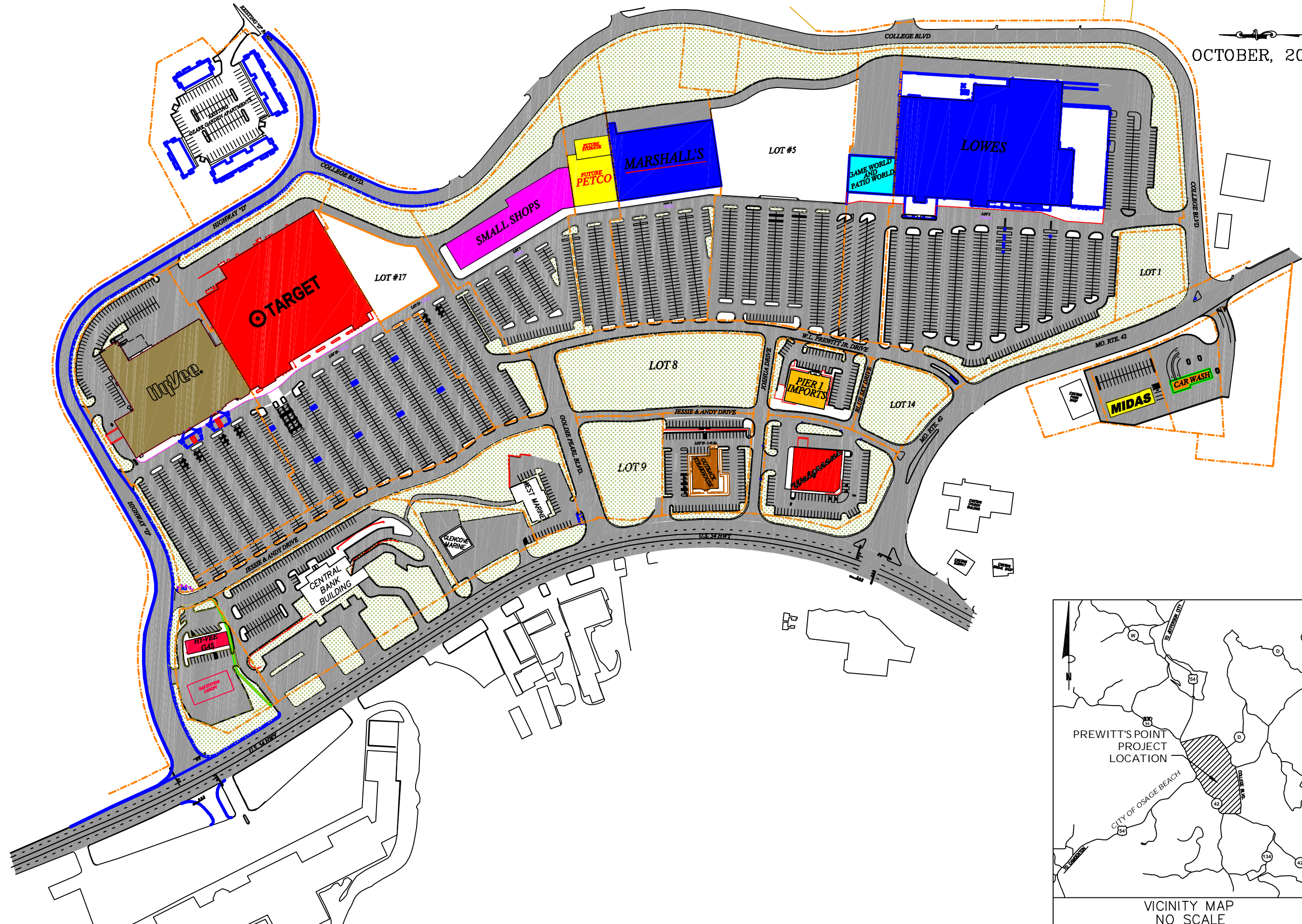

636-584-0540 (tel.)
636-584-0532 (fax)
info@cochraneng.com

530A E. Independence Dr.
Union, Missouri 63084

COCHRAN

- Civil Engineering
- Land Surveying
- Architecture
- Site Development
- General Consulting
- Master Planning

The working drawings are to be used for the start of any excavation on this site, contractor shall call 1-800-96-RISE for utility location information.

All OSHA rules & regulations established for the type of construction required by these plans shall be strictly followed (ie. trenching, shoring, etc.)

OVERALL SITE PLAN
OF PREWITT'S POINT
OSAGE BEACH, MISSOURI

DATE:	DATE:
REVISED:	REVISED:
DRAWN BY:	APP'D BY:
B.A.B.	
DATE:	DATE:
OCTOBER 2005	
SCALE:	SCALE:
NO SCALE	
PROJ. NO:	PROJ. NO:
00-385	
DWG. NO:	DWG. NO:
1 OF 1	

